

Drywall Frame  
Corner detail

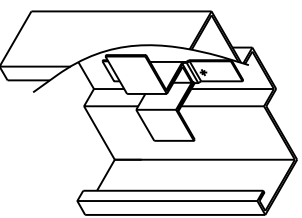

Adjustable compression pod  
(Leveling screw)

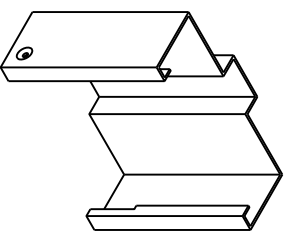

SBA, Screw base  
anchor

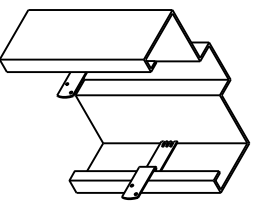

SDS, Snap-in anchor

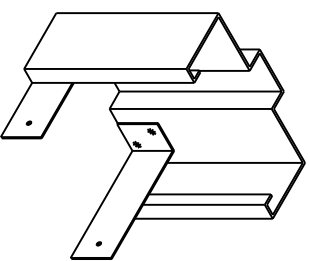

DSA, Drywall strap  
anchor

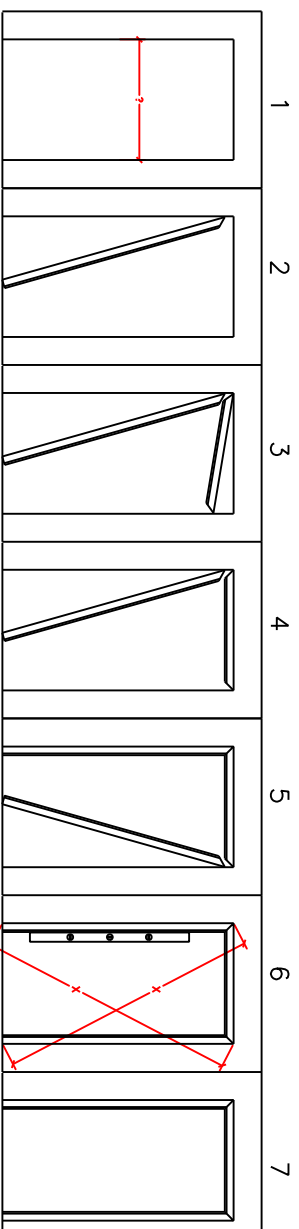

1. Build wall with rough opening height equal to nominal door opening : -height plus 1 1/4" -width plus 2"
2. Install jamb at angle, and let the top of the jamb rest against the opening close to the top.
3. Insert frame head under the corner clips of the jamb and raise into position.
4. Retract leveling anchor in the jamb and finish installing it in position on wall.
5. Insert the corner clips of the opposite jamb into the opposite end of the head and position jamb on wall.
6. After the two vertical jambs are installed with the frame head, measure diagonally from upper left to lower right corner, and from upper right to lower left corner and make sure that "X" dimensions are identical. Install base anchor screws through countersunk holes in frame face or DSA straps and floor plate.
7. Square top of frame and tighten leveling bracket. (Do not overtighten)
8. For cased open KD frames, the rough opening size is equal to finished opening: -height plus 1 1/4" - width plus 2 3/4".

# Knockdown DR Frame Installation

Date:

Drawn by:

Sheet: of:

